

# 1st Floor Lighting and Electrics Plan

19-01-2017

# 1st Floor Lighting and Electrics

## 1st Floor Plan View - Ceiling Spot Lighting (amount of spots may change slightly depending on type used)





# Master Bedroom Bulkhead Lighting Raft

## Bed Wall Overhang for In-Built Lighting - 215 x 215 x 4240mm



An LED strip can be used in a recess cut at the back of the bulkhead to give a subtle wash of light down the wall.

The LED length will be the same width as the bed base

### BULK HEAD PROFILE

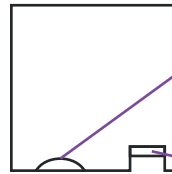

2 x Spots to sit flush with the bottom of the bulkhead.

1 x LED strip in extrusion with diffuser to sit in a cut recess in the bulkhead to give a light wash down the wall but will not be harsh on the eyes when looking up.  
Dimmable LED strip.

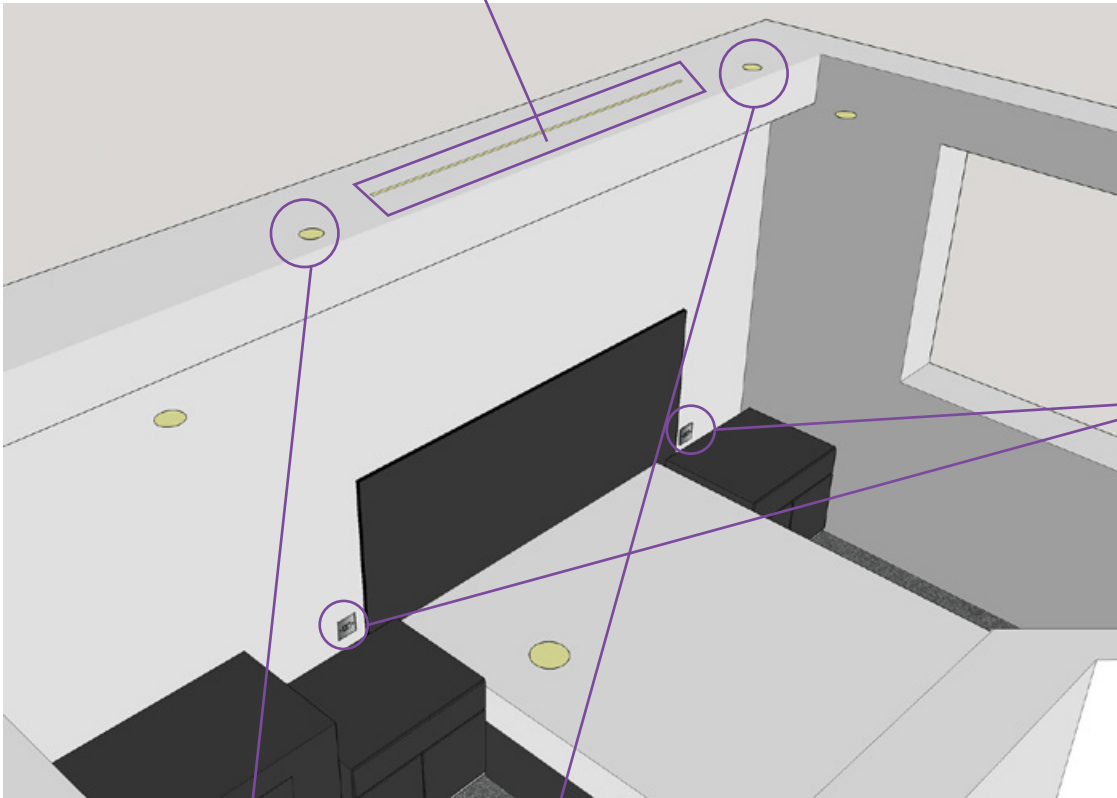

2 gang dimmer switches. One to control their corresponding spotlight and one each to control the LED strip.



The spots, as in this picture, will be on the bottom of the overhang above each bedside table for a nightlight. Each side will have a switch for their own light and for the LED strip wall wash as above.

# Master Bedroom Bespoke Wardrobe Power Point



This is the room as is with current built in wardrobe and closest power supply.

I have designed a bespoke wardrobe which is to be built and fitted by a joiner.

The middle section is to house a 32" TV.

We need a double power point built into the back of the wardrobe.

The joiner has been commissioned this is where we need to discuss ideal timings for electrics 1st and 2nd fix.

I have precise details about all the works to send and discuss.

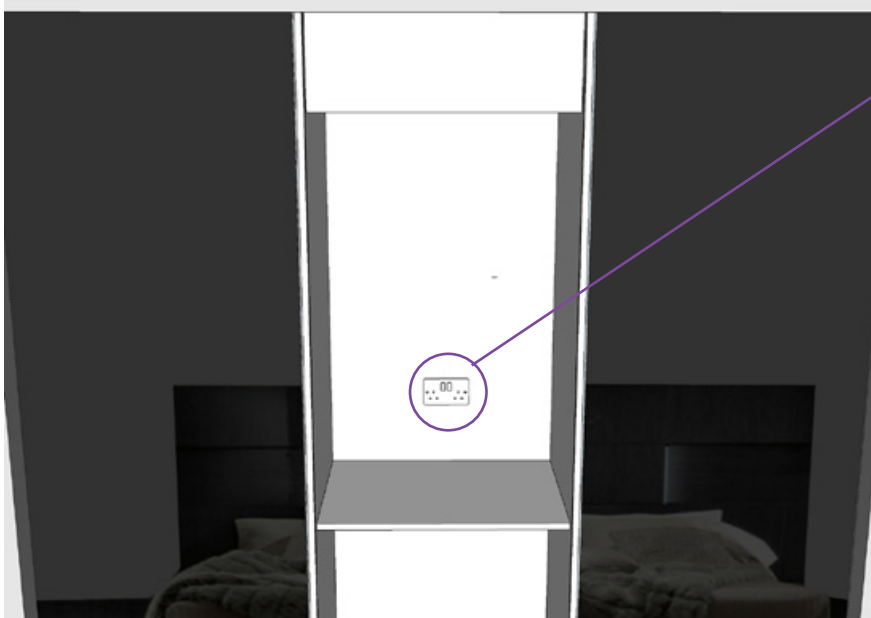

3D Diagram of new power point positioning.

For full 3D model use the link below.

<https://www.dropbox.com/s/ycn5nk2m-fqpzq1/Use%201st%20-Floor%20Lighting%20and%20Electrics.skp?dl=0>

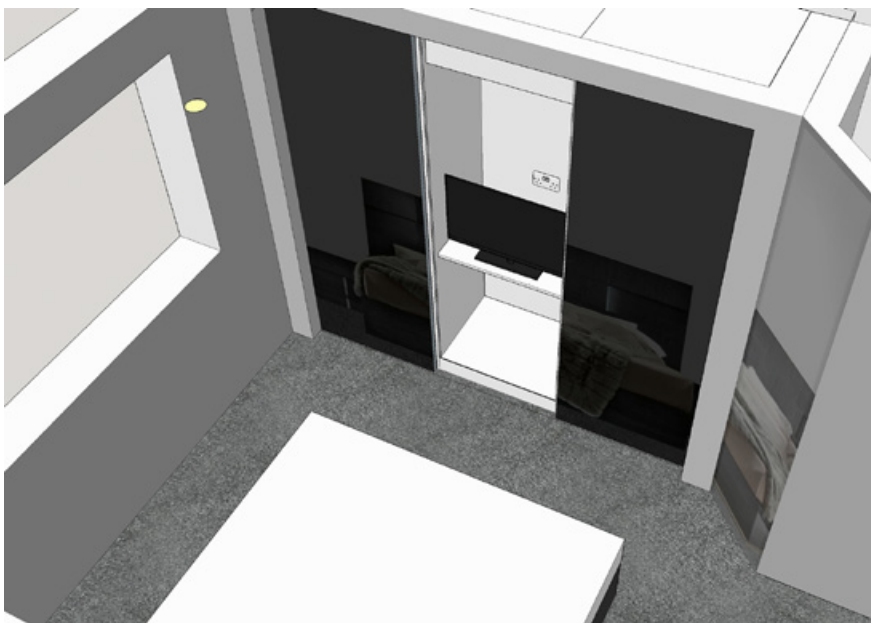

3D Diagram of power point in relation to TV

# Master Bedroom Bespoke Wardrobe Internal Lighting

## Biard Aluminium PIR Sensor Under Cabinet Light 1000mm

Product Code: FDA00110



| Specifications  |                     |
|-----------------|---------------------|
| ✓ Warranty      | 5 Years             |
| ☆ Brand         | Biard               |
| ? Product Type  | LED Cabinet Light   |
| ⚡ Wattage       | 8.5W                |
| ⊕ Dimensions    | 1000 x 20 x 30mm    |
| 📦 Pack Size     | 1                   |
| ✓ Warranty      | 5 Years             |
| ⚡ Input Power   | DC12V               |
| 📜 Certification | CE, RoHS, LVD & EMC |
| ⚖ Weight        | 0.20 KG             |

[View Less Specification](#)

For the internal lighting for the wardrobe we would be looking at something like this.

It would need power feeds in the top left and right of the wardrobe.



The LED lighting in the left hand section



Power in for the LED internal lights.

The surround of the bespoke wardrobe will be built out by the joiner, it is not currently there.

Timings need to be worked out for best synergy between electrician and joiner.

# Light Switches 1

## Dimmer for 4 Ceiling Lights (maybe another dimmer to control another set - to discuss)



## Switches Outside the Ensuite

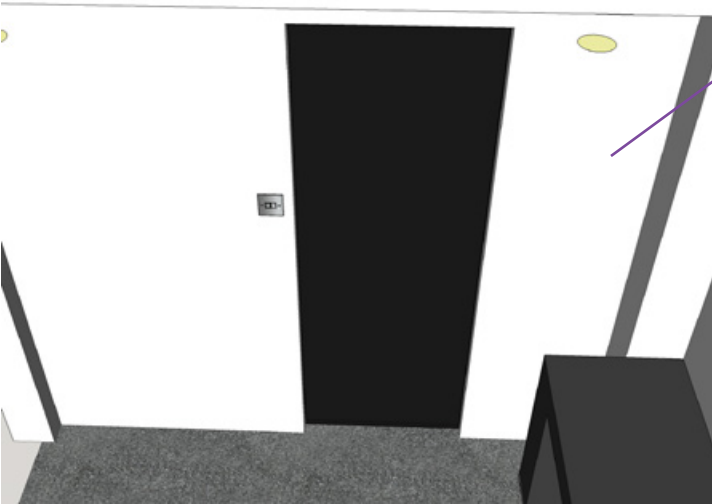

We are replacing the standard door with a glass pocket door which slides into the stud. all the details can be sent on request.

This will require a new stud wall to house.

Timings need to be worked out for best synergy between electrician and joiner.



the client has requested that the isolator switch that is above the door be moved to the same position as the light switch.

## Light Switches 2

Left Bedside Switch for Spot Above and Second Switch for LED Strip

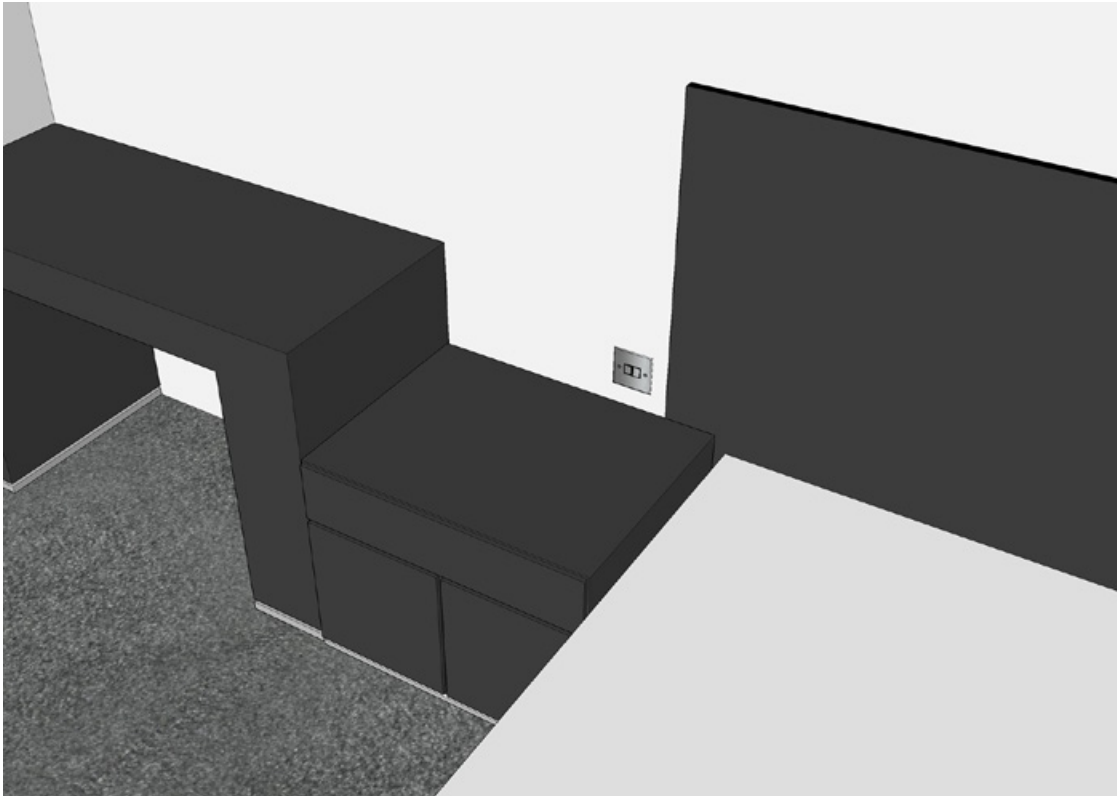

Right Bedside Switch for Spot Above and Second Switch for LED Strip

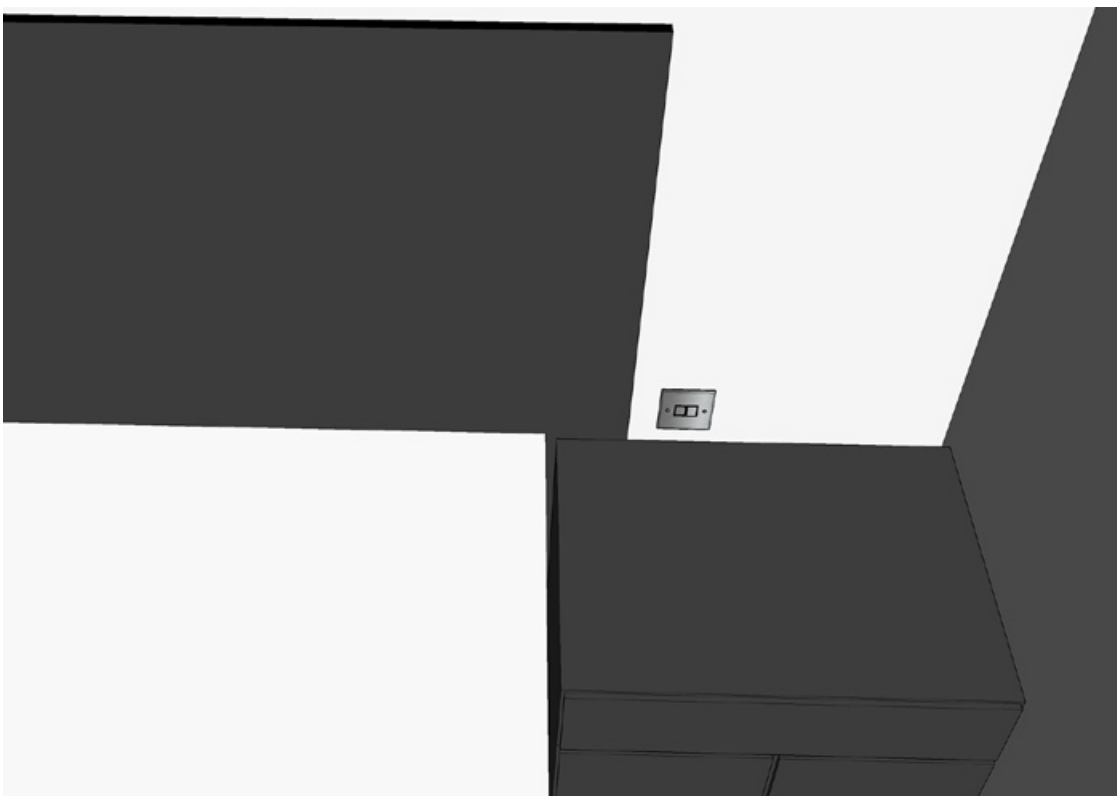



# Power Points to Add - Overview

A Double Power Point to be added at the back of the wardrobe for TV



A Double Power Point under the Dressing Table

